

Location: LINCOLN ELEMENTARY SCHOOL

CITY OF OAKLAND
TRAFFIC ENGINEERING
WORK ORDER

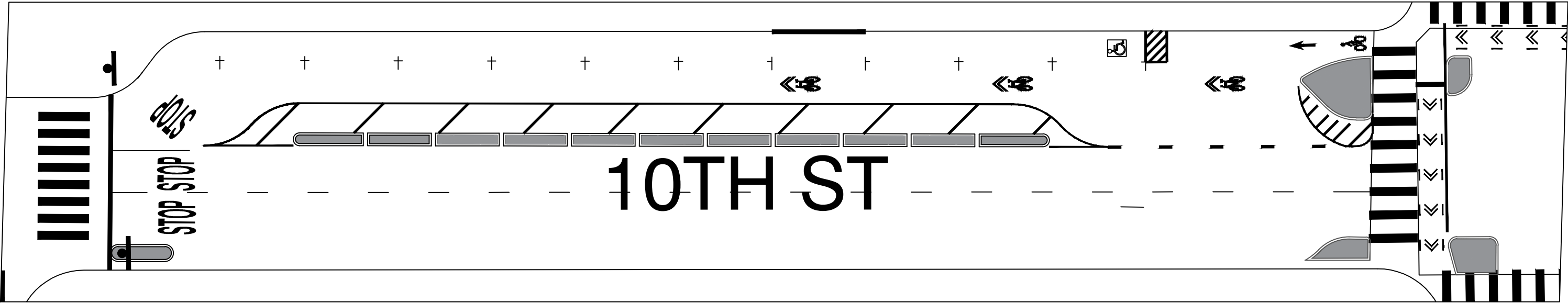
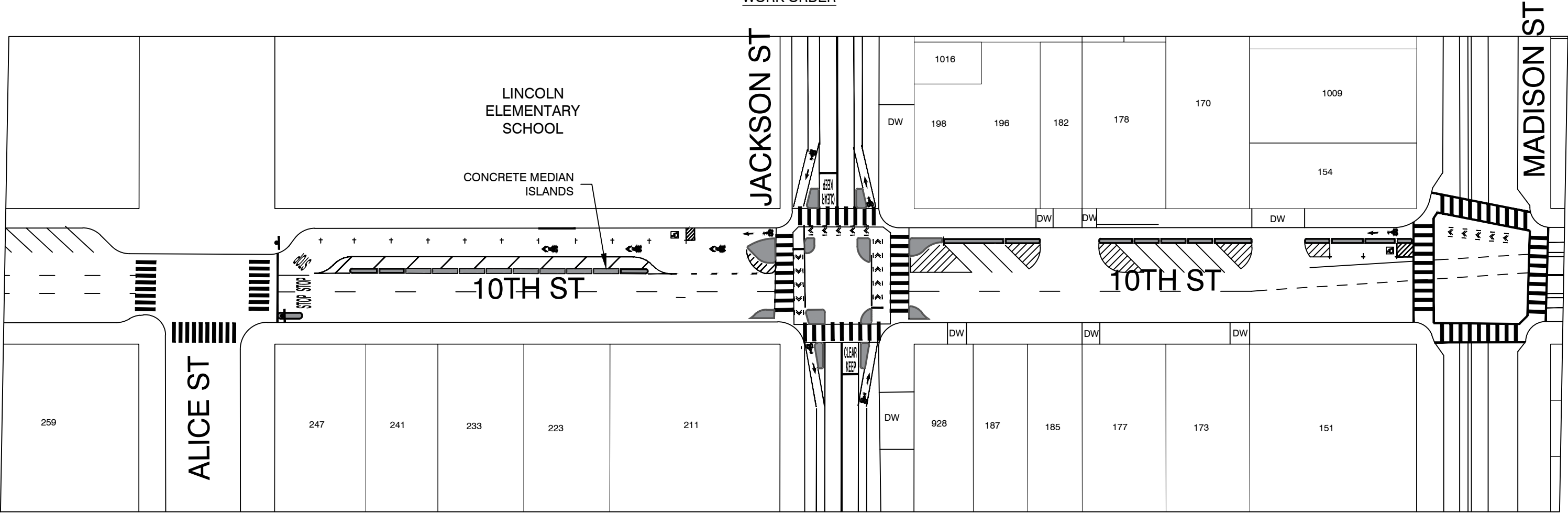

CITY OF OAKLAND
DEPARTMENT OF TRANSPORTATION - SAFE STREETS DIVISION
TRAFFIC ENGINEERING
250 FRANK H. OGAWA PLAZA, SUITE 4344
OAKLAND CA, 94612

ALAMEDA COUNTY SAFE ROUTES TO SCHOOL
LINCOLN ELEMENTARY SCHOOL

SHEET
1 OF 1