

Exhibit C

Vision 980 Scenarios Presentation

Summer 2025



Reconnecting Communities

Exhibit C

Phase 1

Identify a new concept and vision for transportation and land use along the entire I-980 corridor.

Spring 2024 – Fall 2025

Phase 2

Perform a more detailed feasibility and technical analysis of the concept/vision

Early 2026 – Late 2027

Develop an evaluation framework to ensure the vision meets equity performance measures or benchmarks.

Vision 980 Study Goals



1. Create community-informed transportation+ project concepts that improve all aspects of quality of life in Oakland



2. Develop equity outcomes that directly benefit West Oakland residents



3. Foster a more sustainable West Oakland neighborhood



4. Identify public policies to achieve anti-displacement and anti-gentrification project concepts



5. Engage the community with humility to earn a meaningful and long-lasting relationship



Exhibit C

Project Area Sector Boundaries

West of San Pablo

- **Primarily depressed below grade**
- On/off ramps are barrier to connectivity
- All but one overpass is West of SP
- Oakland's Central Business District

East of San Pablo

- **Primarily elevated above grade**
- All but one underpass is East of SP
- Elevated BART tracks fully East of SP
- Uptown Entertainment District and Alta Bates Summit Medical Center

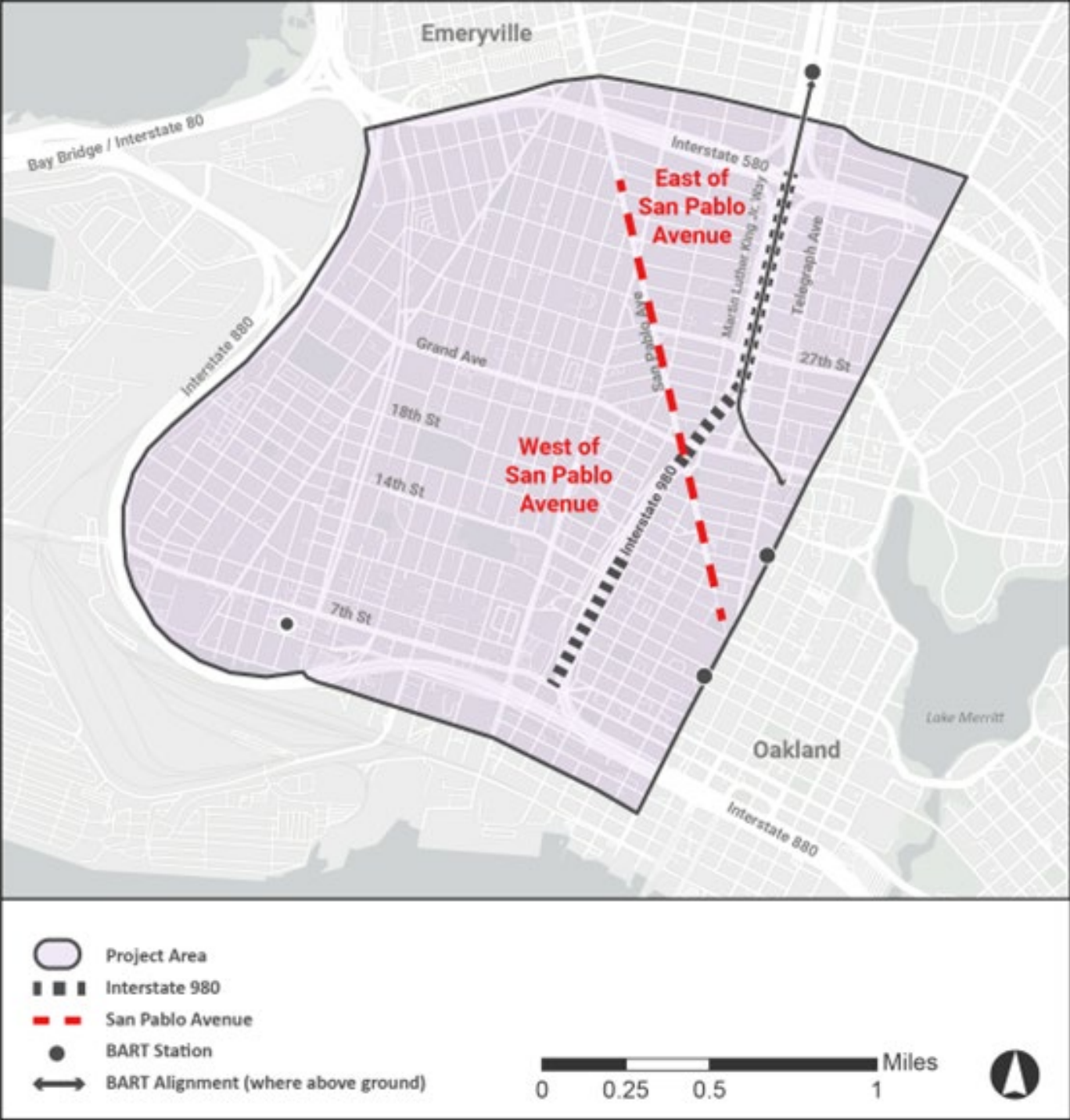



Exhibit C

Scenarios & Strategies to Reconnect

Enhance

1. **Planned Investments**
2. **Improve Over/Under Pass Conditions**

Cover

3. **Cap/Deck Over Travel Lanes**

Remove

4. **Remove On/Off Ramps**
5. **Narrow Roadway**
6. **Reconnect Street Grid**
7. **Demolish and Remove the Freeway**
8. **New At-Grade Boulevard**
9. **Reconfigure Freeway Interchanges**

**Minimal
Intervention**

**Maximum
Intervention**

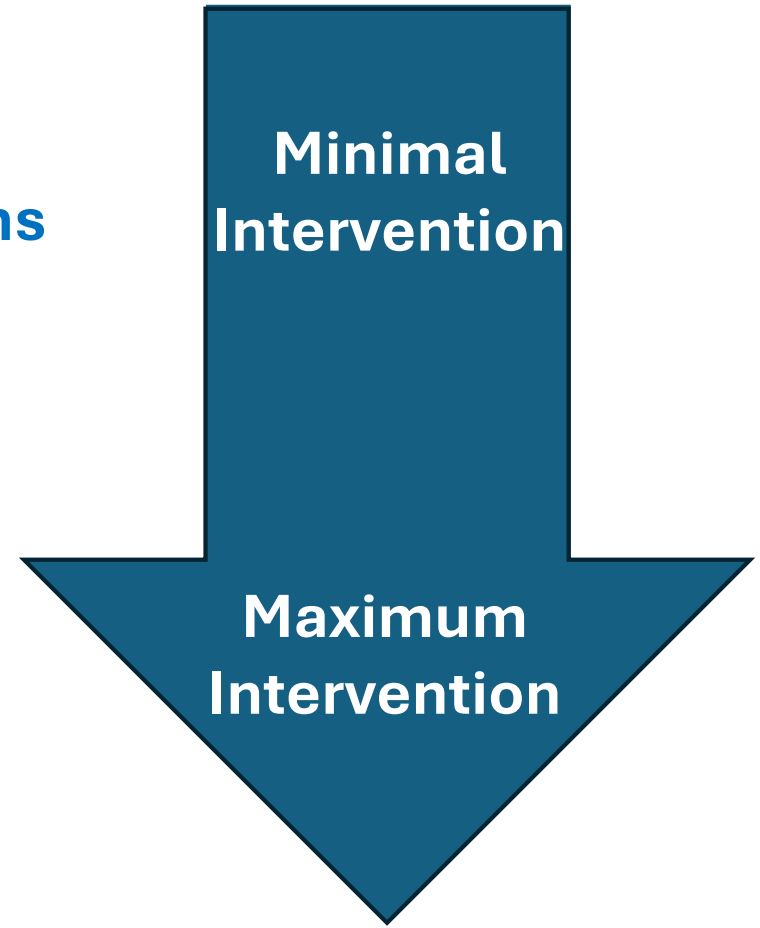

Exhibit C

Enhance Corridor Scenario

- Planned Investments
- Improved Over/Under Pass Conditions
- Enhances bicycle/pedestrian safety and experience
- Does not create any additional crossings
- No additional land for new development
- Full freeway infrastructure remains in place
- Lowest intervention and cost/time/construction impacts



Exhibit C

Enhance Corridor Scenario

(West and East of San
Pablo Avenue)

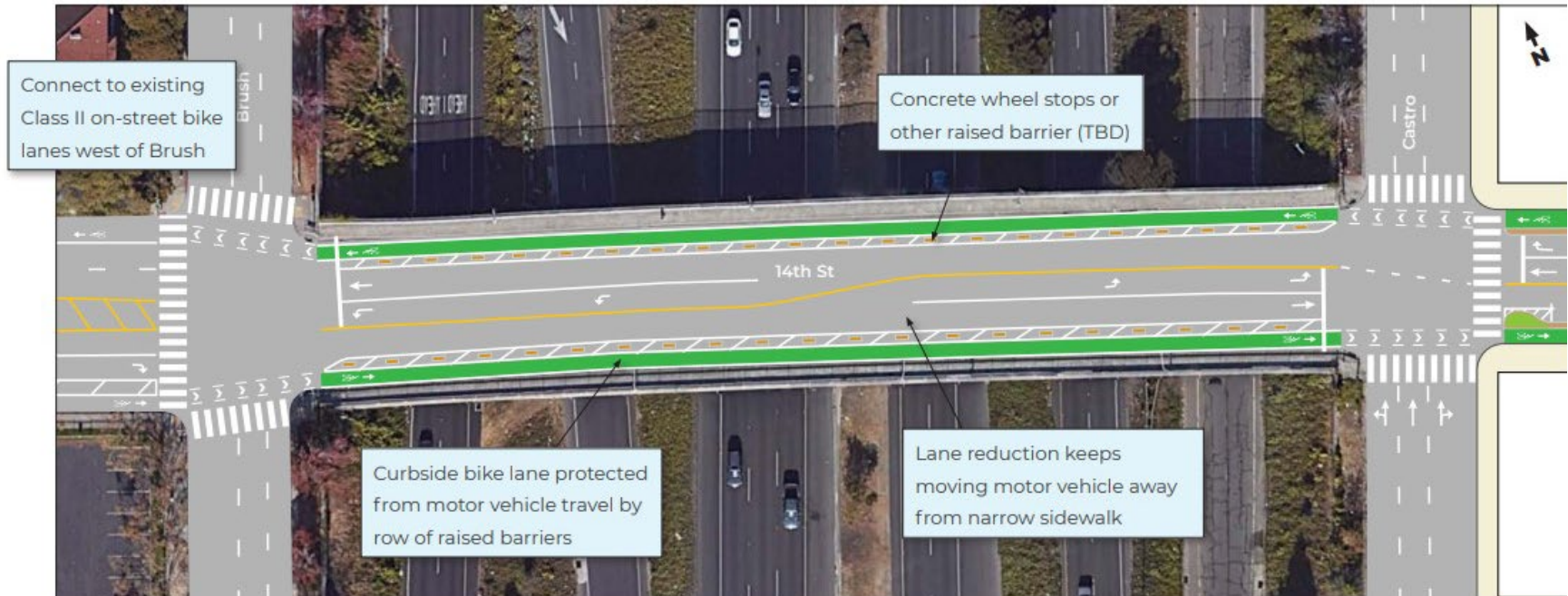

City of Oakland Proposed
14th Street Improvements

Potential to improve I-980 undercrossing at 30th Street

Exhibit C

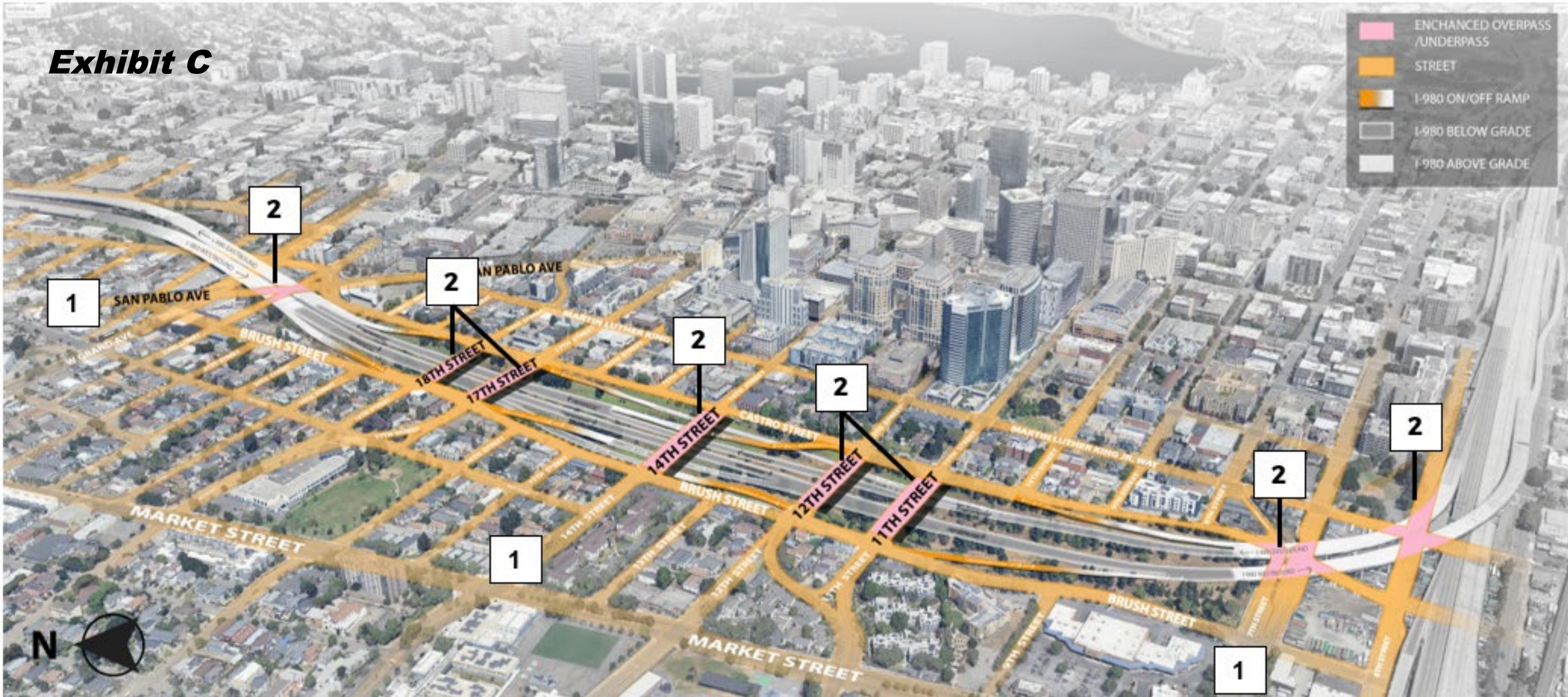

Enhance Corridor Scenario (West of San Pablo Avenue)

Strategies to Reconnect

1. Planned City Improvements
2. Improve Over/Underpass Conditions

Exhibit C

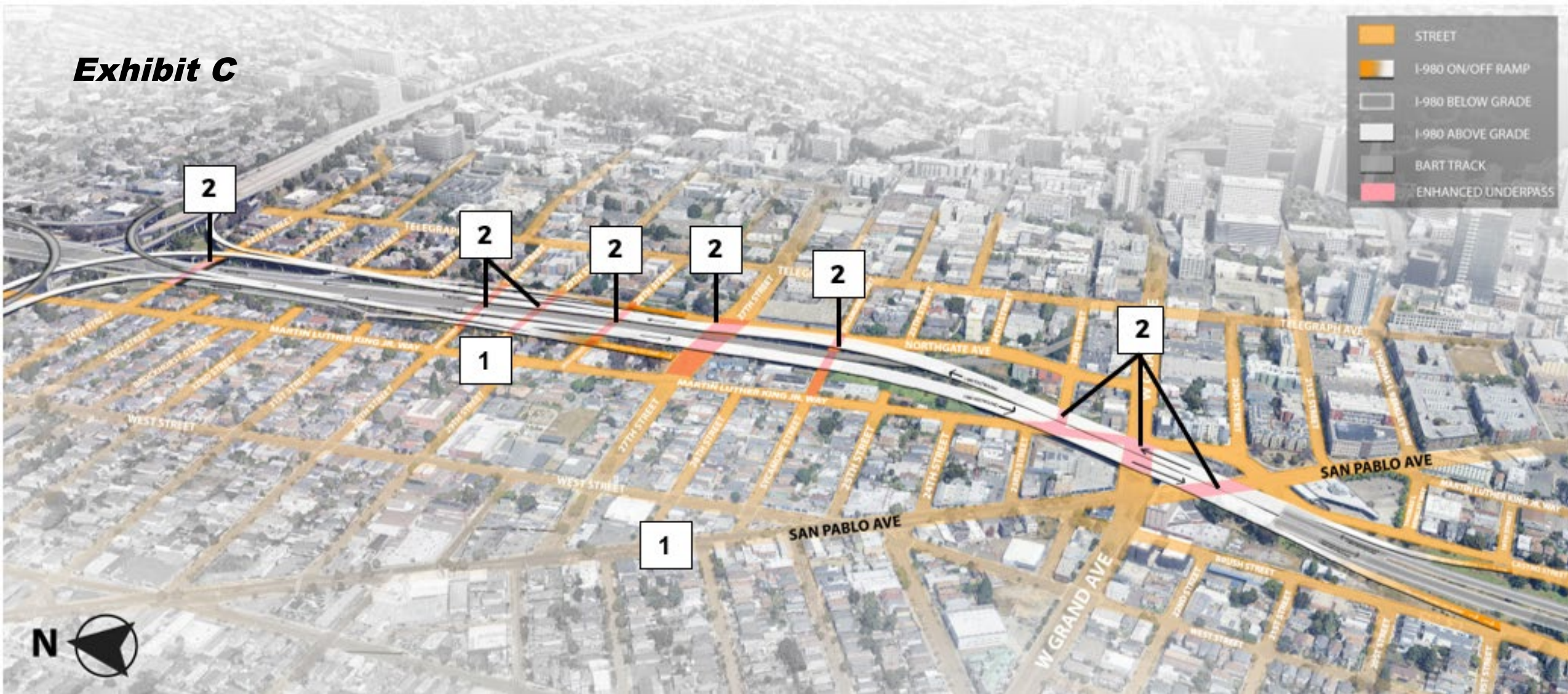

Enhance Corridor Scenario (East of San Pablo Avenue)

Strategies to Reconnect

1. Planned City Improvements
2. Improve Over/Underpass Conditions

Exhibit C

Cover Corridor Scenario

- Includes the Enhance corridor scenario improvements plus:
 - Cap/decks over the depressed freeway west of San Pablo Avenue and between 34th Street & I-580
 - Reconnects some street crossings west of San Pablo
- Frees up to 14 acres of land for new open space, parks and limited development based on community priorities
- Moderate intervention and cost/time/construction impacts



**Cover
Corridor
Scenario
(West of San
Pablo
Avenue)**

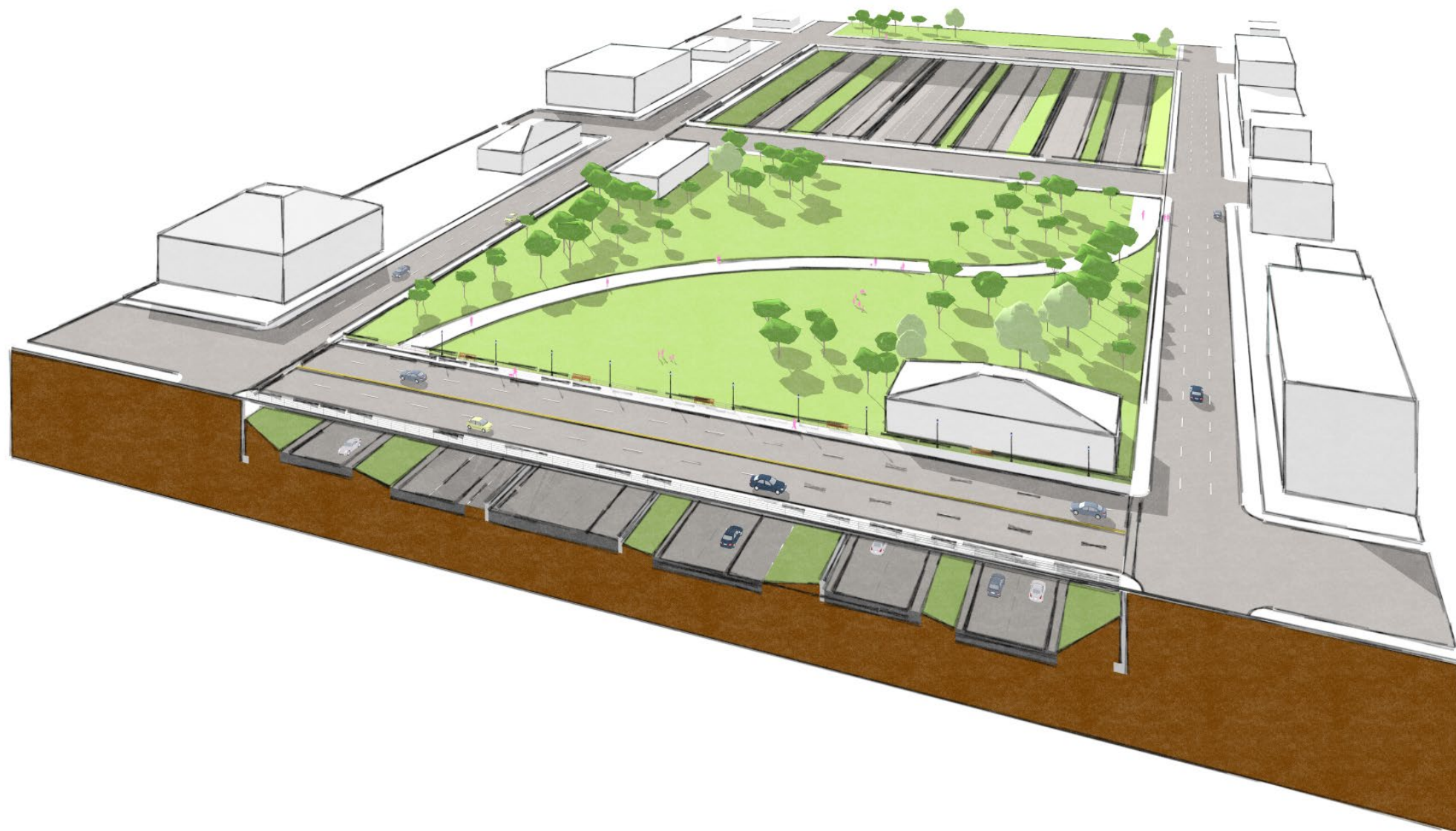
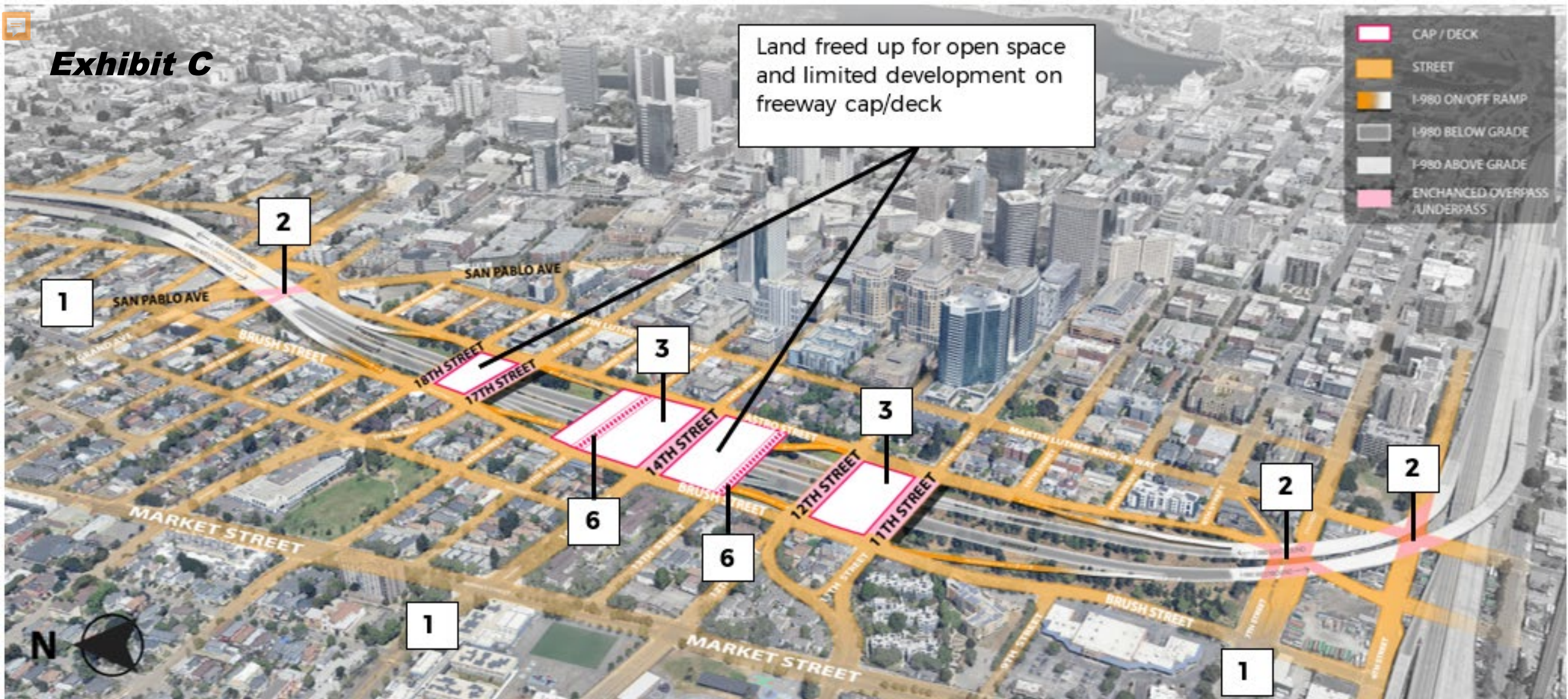

Exhibit C



**Cover Corridor Scenario
(West of San Pablo Avenue)**

Strategies to Reconnect

1. Planned City Improvements
2. Improve Over/Underpass Conditions
3. Cap/Deck Over Travel Lanes
6. Reconnect Street Grid



Exhibit C

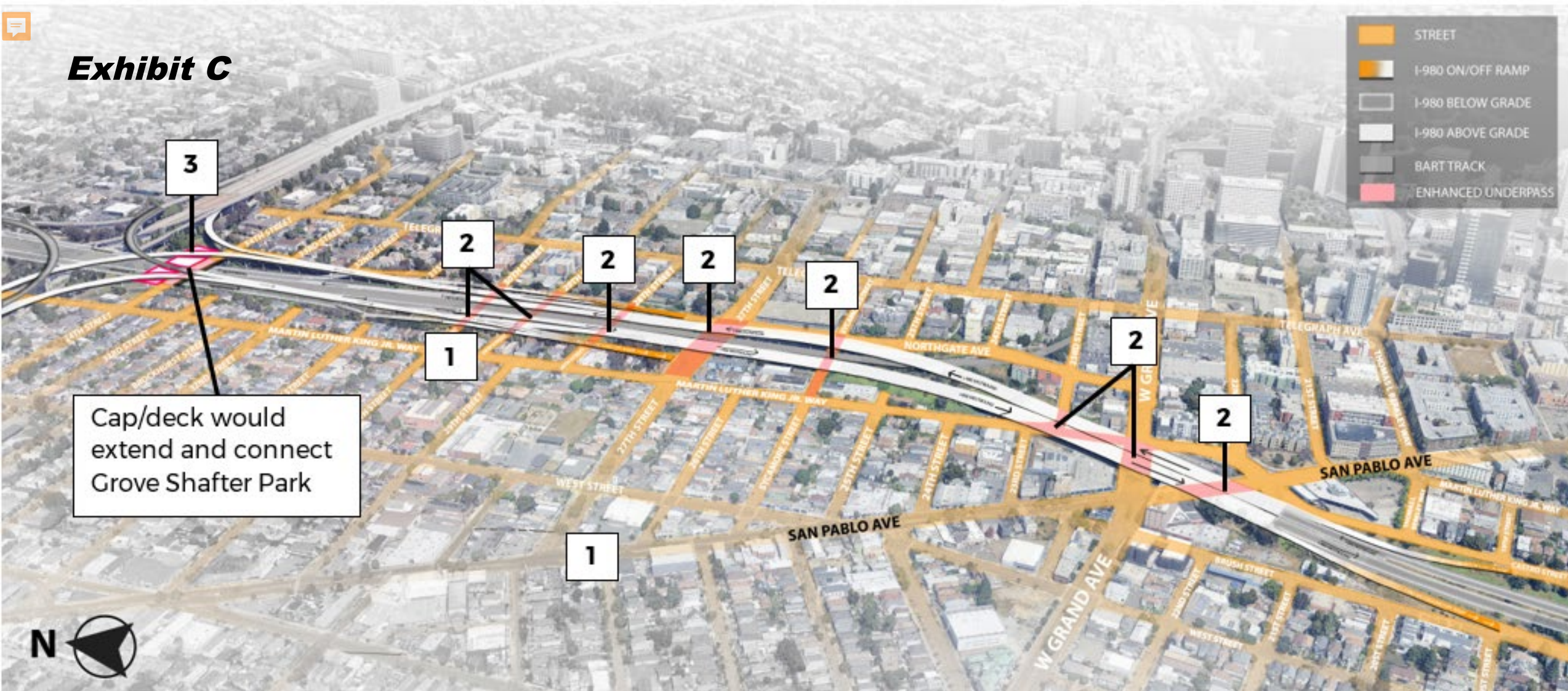

Cover Corridor Scenario (East of San Pablo Avenue)

Strategies to Reconnect

1. Planned City Improvements
2. Improve Over/Underpass Conditions
3. Cap/Deck Over Travel Lanes

Exhibit C

Remove Corridor Scenario

- Includes the Enhance corridor scenario improvements plus:
 - Removes Interstate 980 and redirects traffic to new boulevard
 - Reconnects the street grid that existed before I-980
 - Reconfigures I-880 and I-580 interchanges to new Blvd.
- Frees up to 67 acres of land for new development based on community priorities for the full length of the freeway
- Highest intervention and cost/time/construction impacts



**Remove
Corridor
Scenario
(West of San
Pablo
Avenue)**

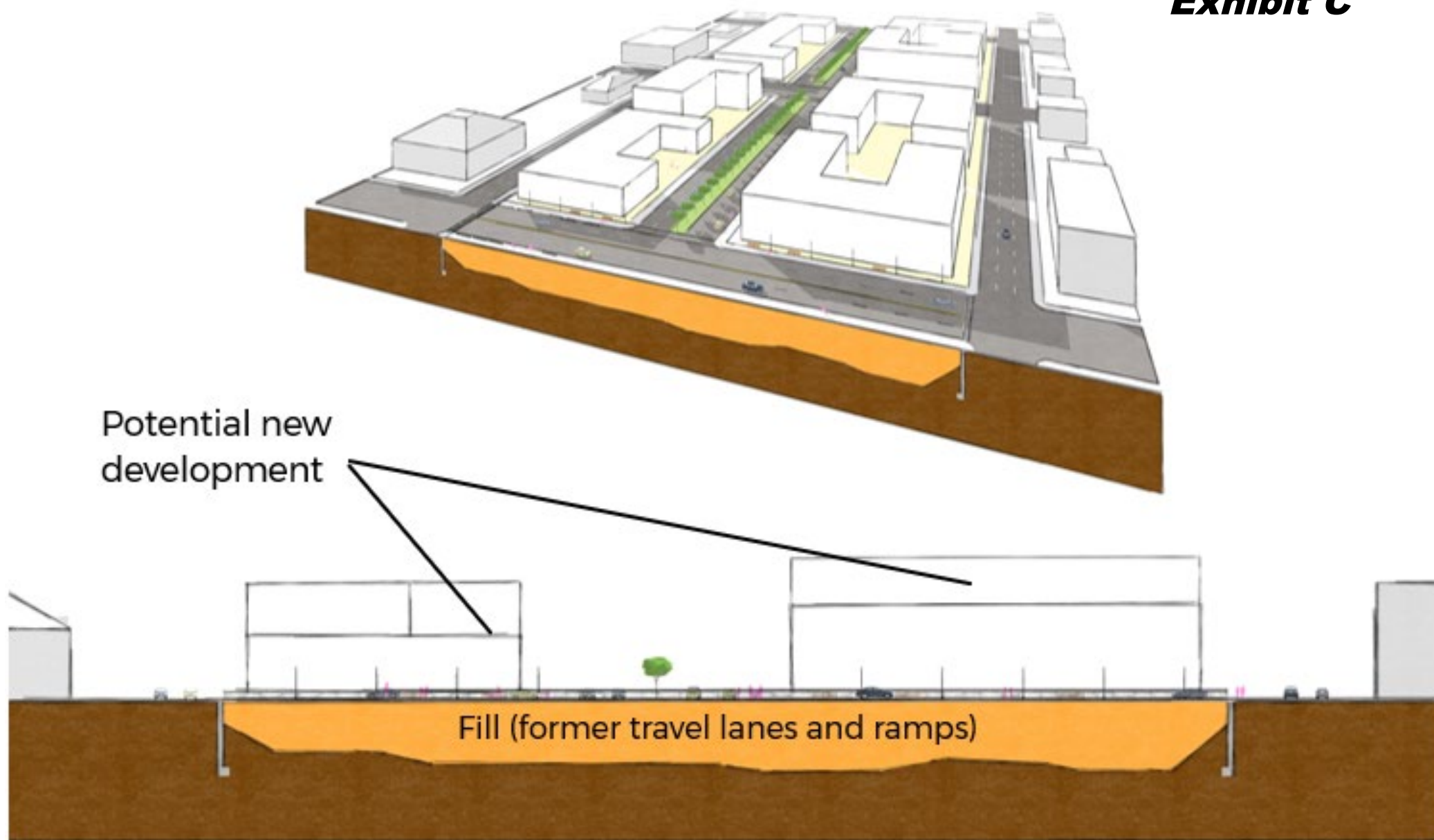
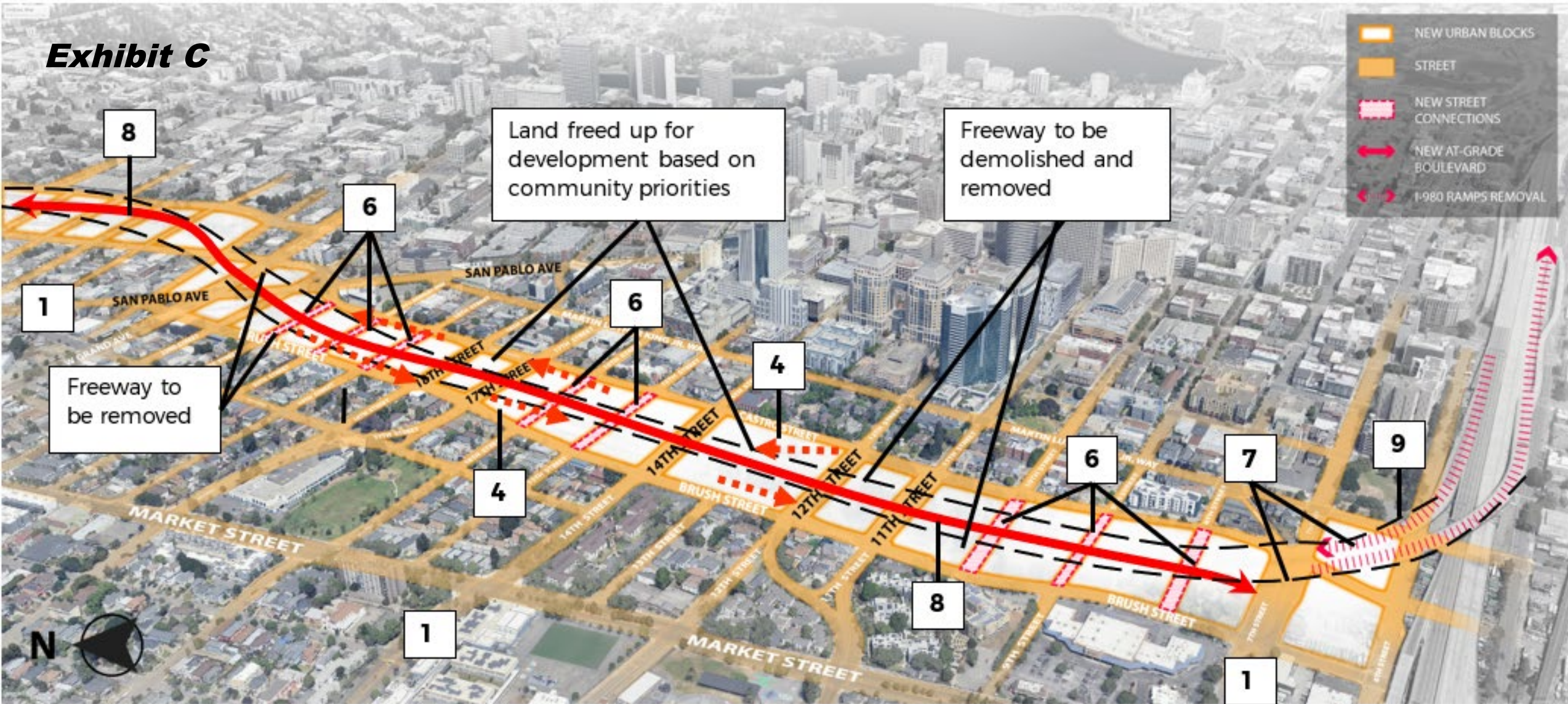

Exhibit C



Remove Corridor Scenario (West of San Pablo Avenue)

Strategies to Reconnect

- 1. Planned Improvements
- 4. Remove On/Off Ramps
- 6. Reconnect Street Grid

- 7. Demolish & Remove Freeway
- 8. New At-Grade Boulevard
- 9. Reconfigure Freeway Interchanges

Exhibit C

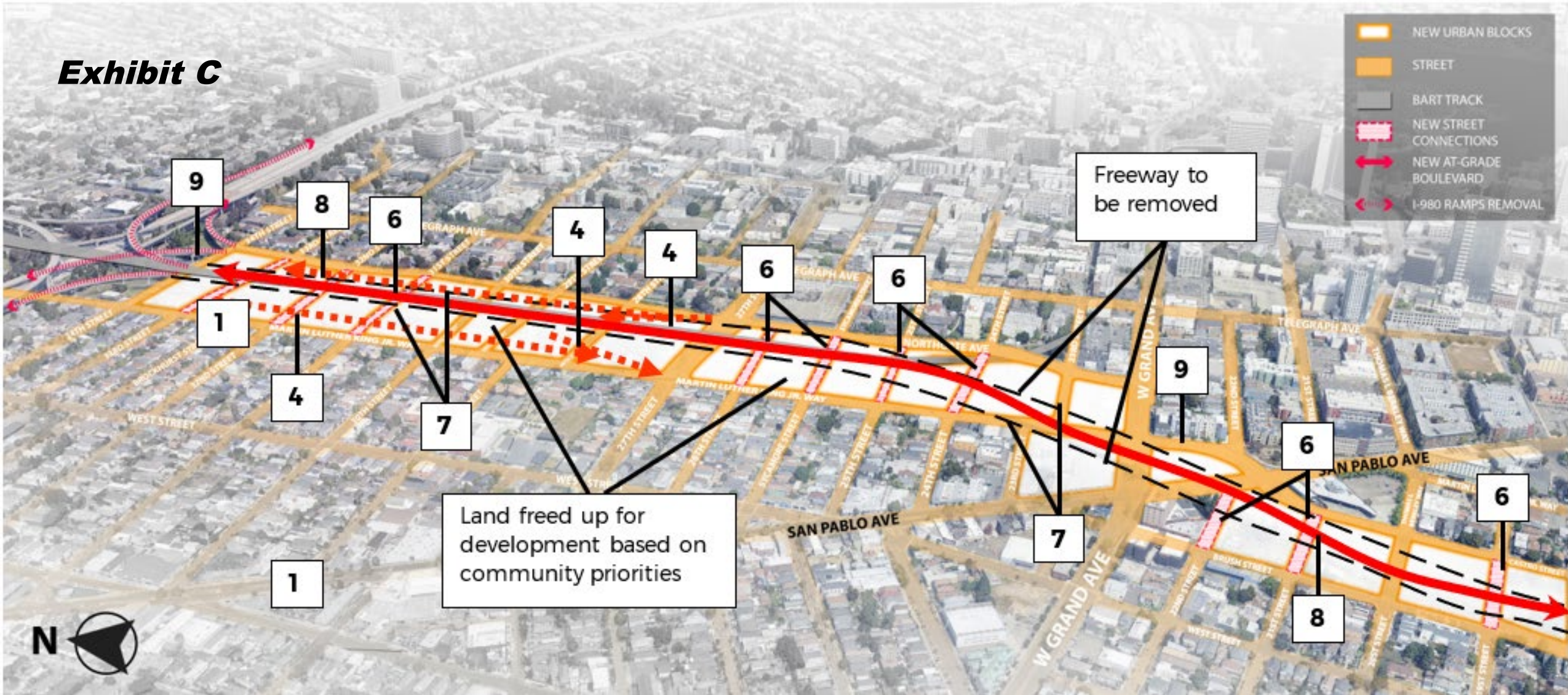

Remove Corridor Scenario (East of San Pablo Avenue)

Strategies to Reconnect

1. Planned Improvements
4. Remove On/Off Ramps
6. Reconnect Street Grid

7. Demolish & Remove Freeway
8. New At-Grade Boulevard
9. Reconfigure Freeway Interchanges

<div data-bbox="0 0 50 64" data-label="Image"></div> <div data-bbox="137 14 517 228">Equity-Based Performance Measure</div>	Enhance	Cover	<div data-bbox="2242 21 2509 78" data-label="Text"><i>Exhibit C</i></div> Remove
Connectivity	<ul style="list-style-type: none"> Enhances existing crossings Does not create any additional crossings 	<ul style="list-style-type: none"> Some new crossings on cap/decks West of San Pablo Avenue One cap/deck near I-580 East of San Pablo Avenue 	<ul style="list-style-type: none"> Reconnection of the street network that existed before I-980 More direct walking, biking, & driving connections
Neighborhood Character	<ul style="list-style-type: none"> The full freeway remains in place Some neighborhood character opportunities 	<ul style="list-style-type: none"> Potential new public open spaces over freeway, and Limited development on cap/decks 	<ul style="list-style-type: none"> Allows for potential new neighborhood development, and Potential for new public open spaces

Equity-Based Performance Measure	Enhance	Cover	<i>Exhibit C</i> Remove
Community Benefits	<p>Does not free up any additional land for open space or development.</p> <p>Benefits may include:</p> <ul style="list-style-type: none"> • improved safety • community character 	<p>Creates new open space options based on community priorities. Benefits from Enhance plus:</p> <ul style="list-style-type: none"> • open space/parks • cultural & community facilities • events/activation 	<p>Frees up land for new development based on community priorities.</p> <p>Benefits from Enhance & Cover plus:</p> <ul style="list-style-type: none"> • housing • commercial space • job & economic opportunities
Land Use Opportunities	0 acres	up to 14 acres for open space	42 to 67 acres for development
Cost, Time, Construction Impact	Low	Moderate	High

Exhibit C

Summer 2025 Public Outreach Events

- **Mobile Workshop 1:** Thursday, June 19th from 5:00-9:00 PM at the Prescott Night Market (1620 18th St.)
- **Mobile Workshop 2:** Saturday, June 21st from 11:00 AM-6:00 PM at West Oakland Juneteenth celebration (3233 Market St.)
- **Public Meeting:** Wednesday, June 25th from 6:00-8:00 PM at The Center-OUSD Central Kitchen (2850 West St.)
- **Public Survey:** mid-June through mid-July
- **Pop-in to meetings/events hosted by others:** May/June

Thank you!

Visit our website for more info:
www.vision980.org

Contact Info:

Becky Frank,
Community Planning Branch
Chief Caltrans District 4 (Bay
Area) **Vision980@dot.ca.gov**

Randolph Belle
Outreach Lead, RBA Creative
randolph@rbacreative.com



Reconnecting Communities